

UIL Music Region 11 6A Band CSRE  
 Clemens HS • April 3, 2025  
 Host: Matt Boening **UPDATED 3-2-25**  
**Schedule Subject to Change**

| School        | Class | Director              | Warm-Up  | Move     | Concert  | SR       | SR Level/Time |
|---------------|-------|-----------------------|----------|----------|----------|----------|---------------|
| Medina Valley | SNV B | Carlos Navarro        | 8:30 AM  | 8:55 AM  | 9:00 AM  | 9:30 AM  | 4/9           |
| Clemens       | SNVB  | Matt Boening          | 9:00 AM  | 9:25 AM  | 9:30 AM  | 10:00 AM | 4/9           |
| Steele        | SNV   | Alexia Beasley        | 9:30 AM  | 9:55 AM  | 10:00 AM | 10:30 AM | 4/9           |
| Medina Valley | SNV A | Juan Carlos Rodriguez | 10:00 AM | 10:25 AM | 10:30 AM | 11:00 AM | 4/9           |
| East Central  | SNV   | Rick Mendoza          | 10:30 AM | 10:55 AM | 11:00 AM | 11:30 AM | 4/9           |
| Clemens       | SNV A | Zacarias Serrato      | 11:00 AM | 11:25 AM | 11:30 AM | 12:00 PM | 4/9           |
| Judson        | NV    | Jose Garcia           | 11:30 AM | 11:55 AM | 12:00 PM | 12:30 PM | 4/8           |
| Steele        | NV    | Alexia Beasley        | 12:00 PM | 12:25 PM | 12:30 PM | 1:00 PM  | 4/8           |
| Lunch         |       |                       |          |          |          |          |               |
| Clemens       | NV    | Zacarias Serrato      | 1:30 PM  | 1:55 PM  | 2:00 PM  | 2:30 PM  | 4/8           |
| East Central  | NV    | Thomas Esperiqueta    | 2:00 PM  | 2:25 PM  | 2:30 PM  | 3:00 PM  | 4/8           |
| Medina Valley | NV    | Josue Solalinde       | 2:30 PM  | 2:55 PM  | 3:00 PM  | 3:30 PM  | 4/8           |
| Judson        | V     | Laura Braun           | 3:00 PM  | 3:40 PM  | 3:45 PM  | 4:30 PM  | 6/10          |
| Clemens       | V     | Matt Boening          | 3:45 PM  | 4:25 PM  | 4:30 PM  | 5:15 PM  | 6/10          |
| Steele        | V     | Steven Deater         | 4:30 PM  | 5:10 PM  | 5:15 PM  | 6:00 PM  | 6/10          |
| Medina Valley | V     | Juan Carlos Rodriguez | 5:15 PM  | 5:55 PM  | 6:00 PM  | 6:45 PM  | 6/10          |
| East Central  | V     | Ron Garza             | 6:00 PM  | 6:40 PM  | 6:45 PM  | 7:30 PM  | 6/10          |

**JUDGES**

**Concert: Kevin Arnott, Roger Duran, Ronnie Rios SR: Mark Buley, Guillermo De La Cruz III, Benard Rosenberg,**  
**CO: Ed Stein**

**REMINDERS:**

1. Bring three *numbered* scores, Form 1 Eligibility Certification, Announcer Sheet, and Seating Chart (2 copies) to the contest office.
2. **Permission to photocopy POP scores may only be given by the copyright holder, not by a vendor.**
3. An audio recording of your performance will be emailed to you following your performance.
4. Please do not engage with the judges at any time.
5. UIL Music Region 11 utilizes the electronic adjudication system on Texas Music Forms at all concert and sight-reading evaluations. You access your Forms 4 & 5 on TMF under your entries



# Samuel Clemens High School

## ***MIGHTY BUFFALO BAND***

Region 11 Band Directors,

We are looking forward to hosting the UIL Concert and Sight Reading evaluation on Thursday, April 3, 2025!

### Things to consider:

- Directors will need to wear their staff ID's anywhere on SCUCISD property, and they will need to verify entrance for their participating students. Students wearing uniforms and having instruments in hand will establish entrance for these participating students. Participating students need to be accompanied by a director or chaperone when moving around the campus.
- Parent chaperones accompanying students will need school-provided badges to enter our facilities.
- Guests and parents attending the contest (not as chaperones) will need to get a visitor's sticker upon entering the event center (auditorium area).
- All entering schools and guests, when entering the parking lot for the campus, will be greeted by a security guard. You will need to have the parking flyer displayed in the windshield of your car or ready to show the security guard upon entering the parking lot.
- Directors, please make sure your guests and parents that attend have this flyer as well. Parents arriving without a flyer will need to let the security guard know they are attending the UIL Concert & Sight Reading Evaluation to receive a flyer for their dashboard.
  - Parking is very limited on our campus during the school day.

### Bus Information and Contest Rooms/Locations (see maps for additional help with bus drop off and parking):

- Buses will enter from Elbel Road through the entrance on the far side of the stadium.
- Buses will drop directors and students at the rear entrance to the PAC (there is a road that circles around a small building) and then buses will need to park in the area behind the north end of the football stadium.
- Directors should check in at the contest office, located in the Fine Arts Building Ensemble Room (F114), upon arriving. A student guide will meet each director at the drop-off area and take them to the office.
- Cases should be left on buses, as space is extremely limited. If this is not possible due to buses shuttling students and not remaining on campus, please contact me directly.
- There are normal restrooms available in the PAC, but large-scale changing facilities are not available.
- Students will warm-up in the Small Rehearsal Hall (F102), located in the Fine Arts Building
- Students will sight read in the Band Hall (F101), located in the Fine Arts Building
- **Percussion equipment** (other than what is provided) will load in through the backstage door of the PAC. The door will open and *remain* open between band performances... please do not knock 😊.

\*\*\*Don't forget to get the contact information for your bus driver so you can call them when you are ready to load.

\*\*\*Please note that school will be in session. It would be best that when schools are finished performing, they make plans to return to their campus. This will help reduce traffic congestion on campus.

### Equipment we will provide:

- Podiums and director's music stands in Warm-Up, SR Room, and on stage.
- Harmony Director (new model) and McAdams metronome in Warm-Up.
- **All** percussion equipment required for Level 4 & Level 6 Sight Reading pieces will be present in SR Room (Mallets, including chime mallets, bass drum beaters, and triangle beaters, will not be provided).
- Percussion provided on stage: Baby Grand Piano, 5 Adams Timpani, Adams 4.3 octave Rosewood Marimba, Adams Rosewood Xylophone, Yamaha Vibes, Fall Creek Glockenspiel, Concert Bass Drum, Chimes, Large Tam-Tam.

### Things to remember:

- There are classes on the day of the contest, please remind students to be quiet in the hallways and building.
- Don't forget to bring smaller percussion accessory instruments, sticks, mallets, beaters, etc. It would also be helpful for all participants for these instruments to be labeled with your school name.

**Please let me know if you have any questions or specific needs!**

Matt Boening

[mboening@scucisd.org](mailto:mboening@scucisd.org)

830-832-5356 (cell)

# Clemens High School Map

## UIL Band Concert and Sight Reading Evaluation

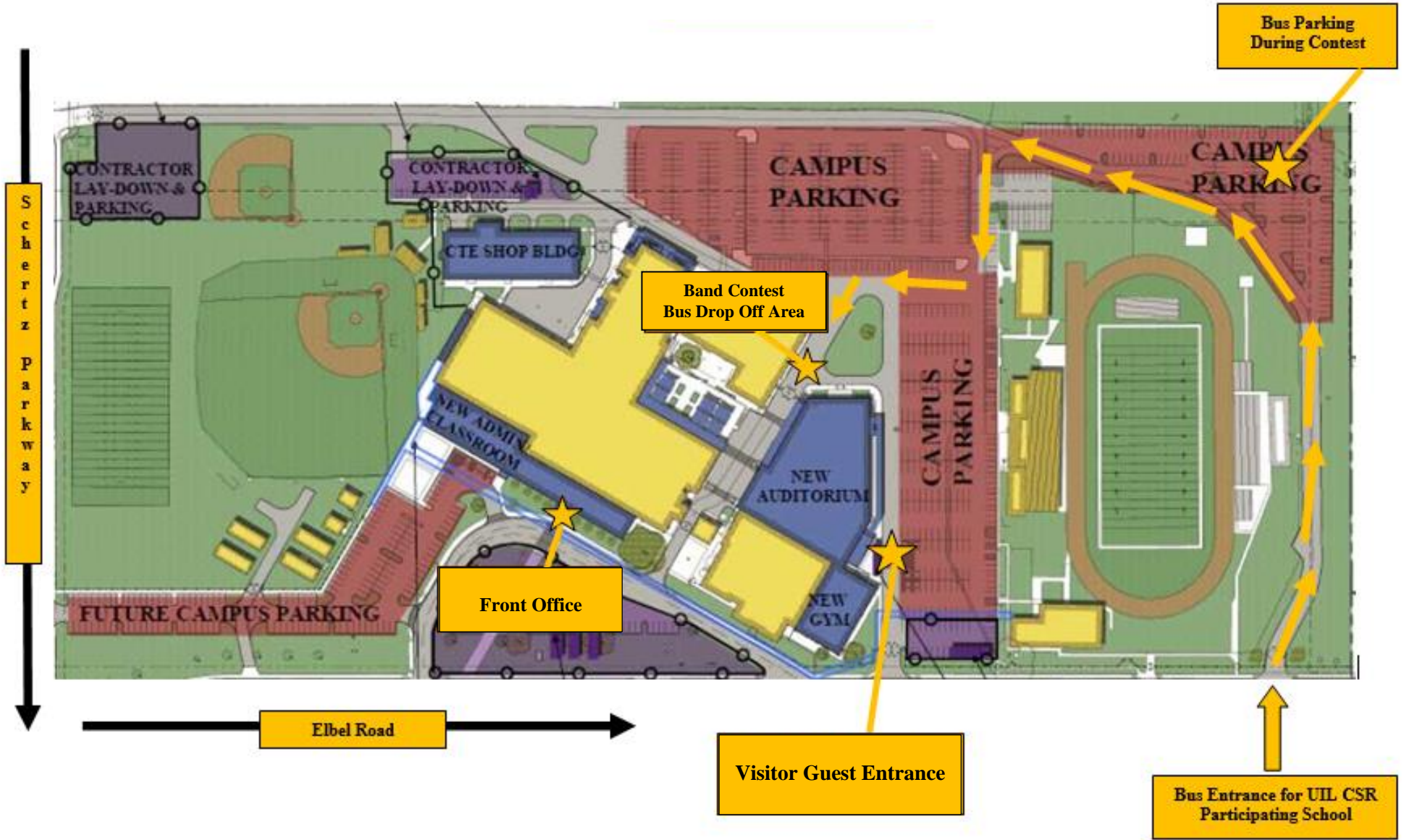

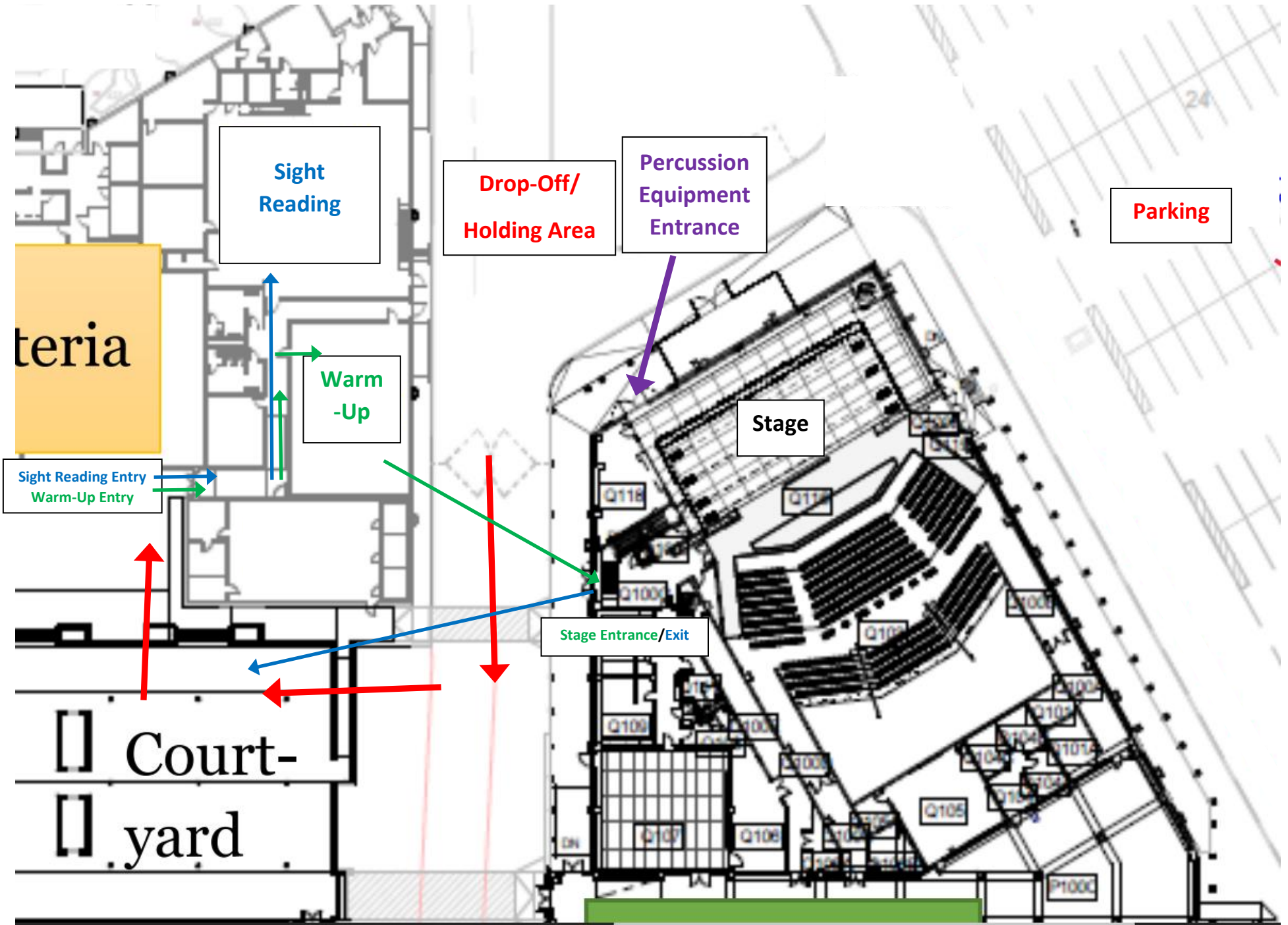

Sight Reading

Drop-Off/  
Holding Area

Percussion  
Equipment  
Entrance

Parking

terria

Warm  
-Up

Stage

Sight Reading Entry  
Warm-Up Entry

Stage Entrance/Exit

Court-  
yard





# **Guest Parking Pass**

**April 3, 2025**



**UIL Concert and Sight  
Reading Evaluation  
Region 11 Band Division**